

### MODEL AUM90NS 90CM CONCEALED RANGEHOOD



24 MONTH  
WARRANTY



90CM



LED  
LIGHTS



10AMP POWER  
CONNECTION

## PRODUCT INFORMATION

### FINISH

- Stainless steel fascia and painted body

### FEATURES

- concealed undermount design
- 2 x 1.5W LED lights
- 56.5 dBA max. noise
- unit is connected to the isolation switch of the cooktop and hard wired to operate at maximum speed when the isolation switch is switched on
- Can only be operated when installed with the CAID604KX / CAID905KX cooktop
- Range hood operates simultaneously with the cooktop operation controls
- Single speed

### FILTERS

- aluminium grease filters
- carbon filter included for re-circulating

### MOTOR

- One speed 475m<sup>3</sup>/hr airflow
- recirculation vent
- Ø150mm ducting

### OPTIONAL EXTRA

- Charcoal filter: D-HXT6009A

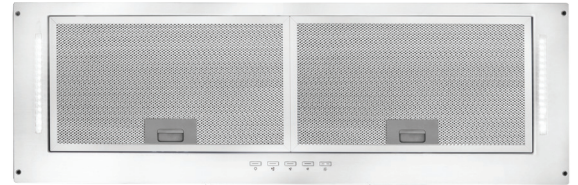

AUM Filters

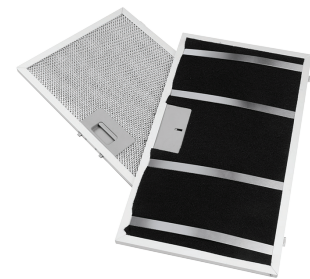

With functionality and ease of use in mind, Artusi have created a range of concealed range hoods that are connected with the Artusi induction cooktops (models: CAID604K & CAID905K) to ensure that the range hood begins and ends operation in synchronisation meaning that cooking odours and cooking smoke are removed from the kitchen, meaning all you'll need to worry about is cooking!



EAN 9347777004116

AR12072021

### DISCLAIMER

Eurolinx PTY LTD, is continually seeking ways to improve the design specifications, aesthetics and production techniques of its products. As a result alterations to our products and designs take place continually. Whilst every effort is made to produce information and literature that is up to date, this brochure should not be regarded as an infallible guide to the current specifications, nor does it constitute an offer for the sale of any particular product. Product dimensions indicated in our literature is indicative only. Actual product only should be used to define dimension cut outs. Distributors, and retailers are not agents of Eurolinx and are not authorized to bind Eurolinx by any express or implied undertaking or representation.

**FOLLOW US ON:**  [instagram.com/artusi\\_appliances](https://www.instagram.com/artusi_appliances)

 [www.linkedin.com/company/eurolinx-pty-ltd-t-a-ilve/](https://www.linkedin.com/company/eurolinx-pty-ltd-t-a-ilve/)

Australia National Telephone Number 1300 (694 583) New Zealand Telephone Number 64 3 344 5913

Artusi showroom hours: Tuesday to Friday - 9am-5pm, Saturday - 10am-4pm, Sunday and Monday - closed

\* Melbourne showroom hours: Tuesday to Saturday - 10am-4pm

[artusi.com.au](https://www.artusi.com.au)

#### NSW & ACT (Head Office)

48-50 Moore Street  
Leichhardt  
F 02 8569 4699

#### QLD

1/42 Cavendish Road  
Coorparoo  
F 07 3397 0850

#### WA & NT

Unit 10/55 Howe Street  
Osborne Park  
F 08 9201 9188

#### New Zealand

PO Box 11.160  
Sockburn Christchurch  
F 03 344 5906

### MODEL AUM90NS 90CM CONCEALED RANGEHOOD

#### TECHNICAL DIAGRAM

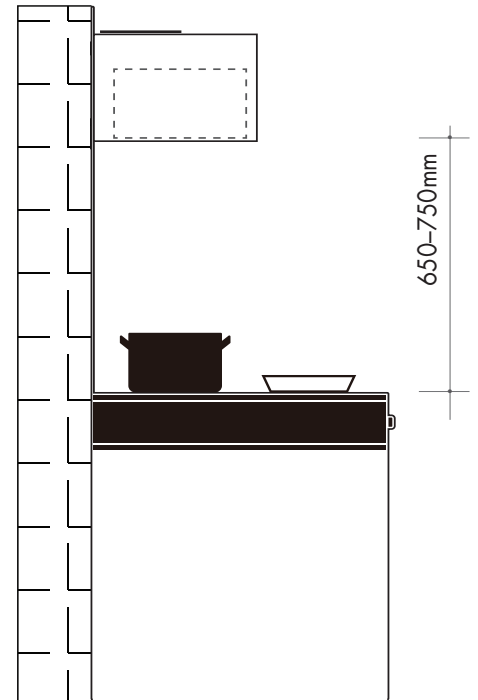
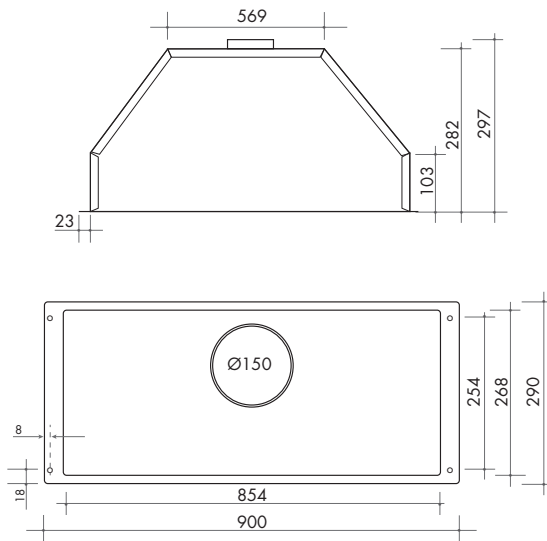

NB: drawings are not to scale — they are to be used for detailed installation instructions, please refer to user guide.

**EAN 9347777004116**

AR12072021

#### DISCLAIMER

Eurolinx PTY LTD, is continually seeking ways to improve the design specifications, aesthetics and production techniques of its products. As a result alterations to our products and designs take place continually. Whilst every effort is made to produce information and literature that is up to date, this brochure should not be regarded as an infallible guide to the current specifications, nor does it constitute an offer for the sale of any particular product. Product dimensions indicated in our literature is indicative only. Actual product only should be used to define dimension cut outs. Distributors, and retailers are not agents of Eurolinx and are not authorized to bind Eurolinx by any express or implied undertaking or representation.

AUM90NS 90cm concealed undermount rangehood  
10 AMP electrical connection, 3-pin plug and cord

**FOLLOW US ON:**  [instagram.com/artusi\\_appliances](https://www.instagram.com/artusi_appliances)

 [www.linkedin.com/company/eurolinx-pty-ltd-t-a-ilve/](https://www.linkedin.com/company/eurolinx-pty-ltd-t-a-ilve/)

**Australia National Telephone Number 1300 (694 583) New Zealand Telephone Number 64 3 344 5913**  
**Artusi showroom hours:** Tuesday to Friday - 9am-5pm, Saturday - 10am-4pm, Sunday and Monday - closed  
**\* Melbourne showroom hours:** Tuesday to Saturday - 10am-4pm

[artusi.com.au](https://www.artusi.com.au)

**NSW & ACT (Head Office)**  
48-50 Moore Street  
Leichhardt  
F 02 8569 4699

**QLD**  
1/42 Cavendish Road  
Coorparoo  
F 07 3397 0850

**WA & NT**  
Unit 10/55 Howe Street  
Osborne Park  
F 08 9201 9188

**New Zealand**  
PO Box 11.160  
Sockburn Christchurch  
F 03 344 5906